

FOR LEASE

West Chester Centre
6068 West Chester Road
West Chester, OH 45069



Property Highlights

- 2,197 SF office/retail space available 2/1/24
- Strong demographics in a highly developed area
- High visibility location just off Union Centre & minutes to I-75
- No earnings tax & 30-day occupancy
- Appealing exterior with many architectural details
- Ample, convenient parking
- Co-Tenants: Skyline Chili, VIP Smoke Shop, Minuteman Press, Break Out Escape Room, Sawasdee Thai restaurant, Charis Coffee, Northstar Church and more!
- Near by: IKEA, 4+ hotels, Lakota West HS, McDonald's, Jag's Steak & Seafood, Dingle House, 6 multi-story Class A office buildings, Towne Square and the Clock Tower
- Asking rate: Call agent (OpEx \$4.82 PSF)



North Ridge Realty Group
7182 Liberty Centre Drive, Suite M | West Chester, OH 45069 | 513.860.5050
Susan Stretch | c: 513.315.8522 | susan@nrrg.com
Marshall Stretch | c: 513.504.8232 | marshall@nrrg.com

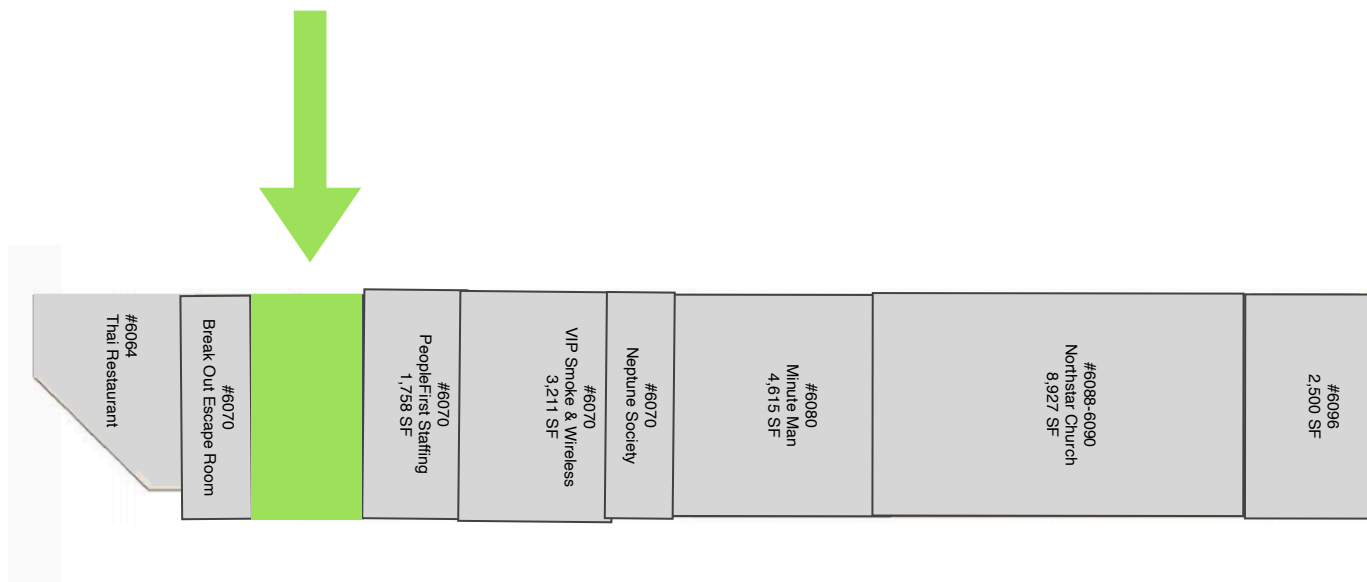

SITE PLAN

Property Details

Location	West Chester, OH (Butler County)
Building Type	Multi-tenant retail/office center
Utilities	Separately metered including water
Space	2,197 SF office/retail
Lease Term	3-5 years
Available	2/1/2024
Asking Rate	Call Agent
Operating Expenses	\$4.82 PSF (includes all OpEx except water)

*The assurance of expertise.
The reputation for results.*

www.nrrg.com



Disclaimer: The Realtor involved in selling the premises is relying on all information provided herein or supplied by owner or owner's sources in connection with the Real Estate. We cannot guarantee this information.

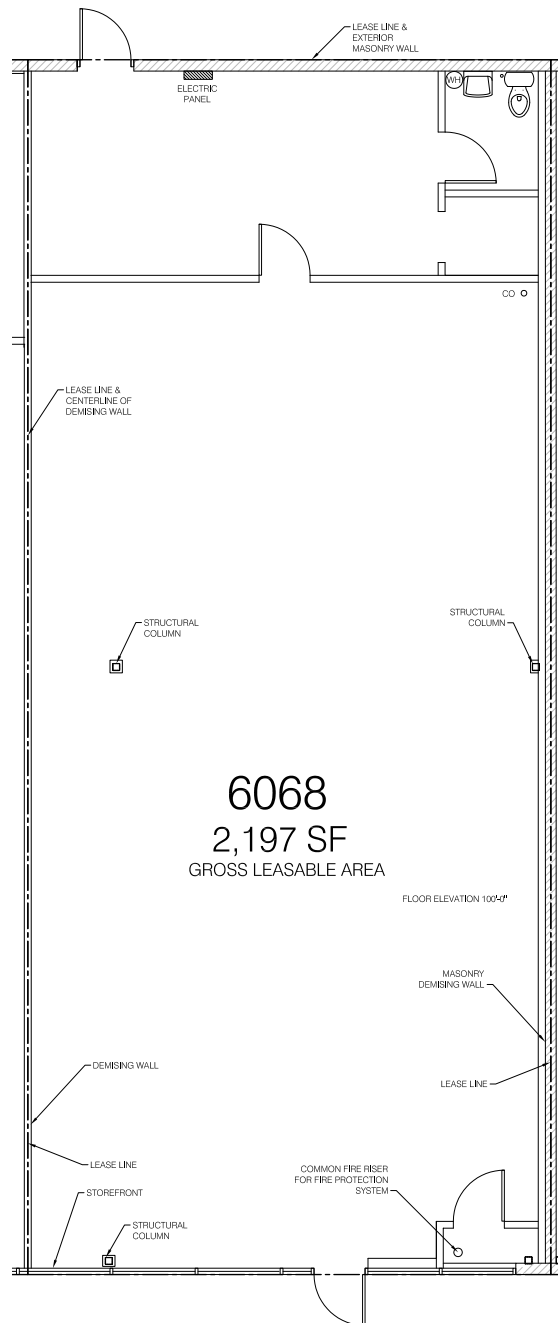

*The assurance of expertise.
The reputation for results.*

www.nrrg.com



Disclaimer: The Realtor involved in selling the premises is relying on all information provided herein or supplied by owner or owner's sources in connection with the Real Estate. We cannot guarantee this information.

Demographic Summary Report

West Chester Centre									
6062-6096 West Chester Rd, West Chester, OH 45069									
Building Type: General Retail			Total Available: 0 SF						
Secondary: -			% Leased: 100%						
GLA: 31,039 SF			Rent/SF/Yr: -						
Year Built: 1999									
Radius		1 Mile		3 Mile		5 Mile			
Population									
2027 Projection		4,115		51,575		140,595			
2022 Estimate		3,955		50,203		136,240			
2010 Census		3,466		47,190		126,221			
Growth 2022 - 2027		4.05%		2.73%		3.20%			
Growth 2010 - 2022		14.11%		6.38%		7.94%			
2022 Population by Hispanic Origin		153		5,351		10,918			
2022 Population		3,955		50,203		136,240			
White		3,059 77.35%		37,833 75.36%		102,702 75.38%			
Black		355 8.98%		5,824 11.60%		17,218 12.64%			
Am. Indian & Alaskan		10 0.25%		228 0.45%		483 0.35%			
Asian		442 11.18%		4,715 9.39%		11,737 8.61%			
Hawaiian & Pacific Island		5 0.13%		306 0.61%		464 0.34%			
Other		84 2.12%		1,297 2.58%		3,637 2.67%			
U.S. Armed Forces		0		0		45			
Households									
2027 Projection		1,503		19,069		52,757			
2022 Estimate		1,441		18,519		51,110			
2010 Census		1,254		17,219		47,144			
Growth 2022 - 2027		4.30%		2.97%		3.22%			
Growth 2010 - 2022		14.91%		7.55%		8.41%			
Owner Occupied		1,302 90.35%		13,547 73.15%		37,645 73.65%			
Renter Occupied		139 9.65%		4,972 26.85%		13,466 26.35%			
2022 Households by HH Income		1,440		18,518		51,109			
Income: <\$25,000		60 4.17%		1,816 9.81%		5,374 10.51%			
Income: \$25,000 - \$50,000		168 11.67%		2,692 14.54%		7,286 14.26%			
Income: \$50,000 - \$75,000		147 10.21%		3,179 17.17%		8,483 16.60%			
Income: \$75,000 - \$100,000		172 11.94%		2,246 12.13%		6,869 13.44%			
Income: \$100,000 - \$125,000		168 11.67%		2,258 12.19%		6,558 12.83%			
Income: \$125,000 - \$150,000		107 7.43%		1,439 7.77%		3,691 7.22%			
Income: \$150,000 - \$200,000		323 22.43%		2,632 14.21%		6,572 12.86%			
Income: \$200,000+		295 20.49%		2,256 12.18%		6,276 12.28%			
2022 Avg Household Income		\$147,754		\$115,061		\$113,812			
2022 Med Household Income		\$126,168		\$92,497		\$91,055			



© 2023 CoStar Group - Licensed to North Ridge Realty Group - 1101347.

3/14/2023

Page 1

Additional demographics provided upon request.